

Hero-MDT-AT5

High-end Quad-core Capacitive Touch Screen MDT

Features

- Android 5.1 OS
- More Powerful CPU, Quad core ARM Cortex-A17, 1.8GHz
- Multi-task processing ability
- Powerful video recording: 2 ch 720p camera recording ability
- H.265 video encoding and decoding
- 4K HDMI video output (4K@60Hz) (option)
- 10/100 Ethernet interface for high speed network (by USB to RJ45 converter)
- Ruggedized design for vehicle environment and operation
- 7-inch 1024*600 capacitive multi-point touch control screen
- 2 Axis Mounting Holder for pan/tilt installation



Technical specification

Model	Hero-MDT-AT5
Hardware	
CPU	Quad core ARM Cortex-A17, 1.8GHz
SOC	RockChip RK3288
RAM Memory	DDR3 2GB
Storage	EMMC 8GB/16GB
Touch screen	Capacity Screen: 7" 1024*600 5mm LCD screen
Storage	Support SD Card, Max 128GB
USB Device	1 x USB 2.0 (Micro USB)
USB Host	2 x USB Host 2.0
UART	1x RS232 (2x232 for option, by adding extension box)
RS485	1 pcs half duplex (optional, by adding extension box)
Output control	1 x 12V control
Input	3 x input status detection
Microphone	1 ch built-in microphone
Speaker	Built-in 8R/2W size, 32mm. (optional audio output for external amplifier, Built in speaker will mute when external audio is on.)
Video input	2 ch 720p USB (1 Megapixel) input. 2ch recording.
Video output	optional
3G/4G	Built-in. 3G/4G module optional.
3G/4G Antenna	built-in antenna
GPS Antenna	SMA external active GPS antenna

www.howentech.com Email: info@howentech.com

Tel: +86-755-86315495, Fax: +86-755-86315496

All rights reserved. Howen Technologies CO., Ltd

Safer world with Howen

Wi-Fi	Built-in
Bluetooth	Built-in
Wi-Fi Antenna	Built-in antenna
Software	
OS	Android V5.1 or Ubuntu 14.04
Audio format	MPEG-3, WMA, etc.
Video format	MPEG-4, AVI, RMVB, etc.
Picture format	JPG, BMP, GIF, etc.
Text format	TXT
TTS voice	Support
Image hard decoding	H.264/H.265 encoding/decoding
Navigation	Support Android navigation software. Support pinch to zoom (capacitive screen)
SDK	Test APP and source code for programming guidance
Communication	
	Support 3G and LTE modules optional. (PCI e mini card).
	Default: WCDMA/HSDPA/HSUPA/HSPA+: Band 1, Band 8, all bands with diversity
3G/4G	GSM/GPRS/EDGE: 850 MHz/900 MHz/1800 MHz/1900 MHz
	Optional: WCDMA/HSDPA/HSUPA/HSPA+: Band 1, Band 2, Band 5, all bands with diversity
	GSM/GPRS/EDGE: 850 MHz/900 MHz/1800 MHz/1900 MHz
	GPRS: UL 85.6 kbit/s; DL 85.6 kbit/s
DATA	EDGE: UL 236.8 kbit/s; DL 236.8 kbit/s
	WCDMA PS: UL 384 kbit/s; DL 384 kbit/s
	HSPA+: UL 5.76 Mbit/s; DL 21.6 Mbit/s
GSM Voice	optional
Sensitivity	-110dBm
3G antenna gain	3.3 dB
GPS	
GPS module	u-blox M7
Receiver Type	L1 frequency band, C/A code, 22 tracking
Sensitivity	-165dBm (tracking), -148dBm (Acquisition)
GPS antenna gain	Built in antenna 1.5dB, external antenna: 3dB
Accuracy	≥15m(position),0.1m/s(velocity)
	36s (cold start)
Acquisition Time	33s (warm start)
	1s (hot start)
	<1s (Re-Acquisition)
Upload frequency	1 Hz
General	
Power	8-32V
Power consumption	<10W
Dimension	29*123*193mm
Working temperature	-20°C ~ +70°C
Storage temperature	-40°C ~ +80°C

Protection	IP64
Vibration test	5-300HZ, 2G

Cable

1, 4255-2x3 6 pin external port male (1pcs)

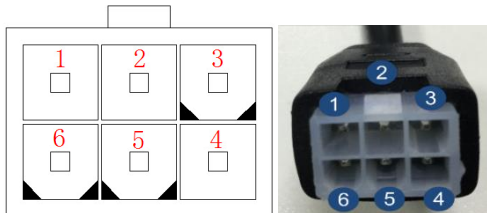

Front view

Pin No.	Definition	Description
1	RS232 TX	RS232 Transmission
2	RS232 RX	RS232 Reception
3	Device GND	RS232 GND
4	ACC	ACC input
5	Power +	Battery positive pole
6	Power GND	Ground

2, 4255-2x2 4pin external port (1pcs)

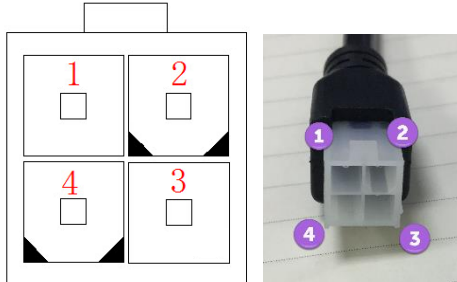

Front view

Pin No.	Definition	Description
1	12V out	12V output
2	Input 1	Input detection 1
3	Input 3	Input detection 3
4	Input 2	Input detection 2

3, USB Type A female external port (2 pcs of USB host ports)

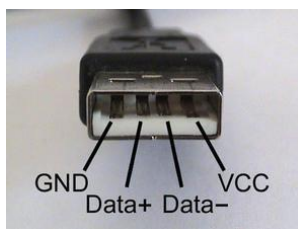

Front view

Pin No.	Definition	Description
1	VCC	5V output
2	Data+	Data positive
3	Data-	Data-
4	GND	Ground