

Hero-MDT-AT2

7 Inch Capacitive Touch Control MDT

Features

- All in one ruggedized vehicle MDT: serial, IO, for connection
- Android OS, Dual core ARM Cortex-A7 processor, 1GHz
- Ruggedized design for vehicle environment and operation
- 7-inch 1024*600 capacitive multi touch control screen
- Selected vehicle level components
- 2 Axis Mounting Holder for pan/tilt installation



Front view

Application

- Taxi dispatch
- Logistics vehicle dispatch
- Personal Location Services
- Real-time monitoring
- Vehicle Management, etc.



Back view



Pan/Tilt Holder

Technical specification

Model	Hero-MDT-AT2
Hardware	
CPU	Dual core ARM Cortex-A7, 1GHz
RAM Memory	DDR3 1GB
Storage	EMMC 8GB
Touch screen	Capacity Screen: 7" 1024*600 5.7mm LCD screen
Storage	Support SD Card, Max 128GB
USB Device	1 x USB 2.0 (Micro USB)
USB Host	1 x USB Host 2.0
UART	1 x RS232 (2 x RS232 optional by adding extension box)
RS485	1 pcs half duplex (optional by adding extension box)
Output control	2 x 12V control (from 4PIN Aviation interface)
Input	3 x input status detection
Microphone	1 ch built-in microphone
Speaker	Built-in 8R/2W size, 32mm. (optional audio output for external amplifier, Built in speaker will mute when external audio is on.)
Video input	2 ch D1 input. Default 4 PIN aviation connectors
Video output	N/A
3G/4G	Built-in. 3G/4G module optional.
3G/4G Antenna	built-in antenna

GPS Antenna	SMA external active GPS antenna
Wi-Fi	Built-in
Bluetooth	Built-in
Wi-Fi Antenna	Built-in antenna
Software	
OS	Android V4.2.2
Audio format	MPEG-3, WMA, etc.
Video format	MPEG-4, AVI, RMVB, etc.
Picture format	JPG, BMP, GIF, etc.
Text format	TXT
TTS voice	Support
Image hard decoding	H.264 encoding/decoding
Navigation	Support Android navigation software. Support pinch to zoom (capacitive screen)
SDK	Test APP and source code for programming guidance
Communication	
	Support 3G and LTE modules optional. (PCI e mini card).
	Default: WCDMA/HSDPA/HSUPA/HSPA+: Band 1, Band 8, all bands with diversity
3G/4G	GSM/GPRS/EDGE: 850 MHz/900 MHz/1800 MHz/1900 MHz
	Optional: WCDMA/HSDPA/HSUPA/HSPA+: Band 1, Band 2, Band 5, all bands with diversity
	GSM/GPRS/EDGE: 850 MHz/900 MHz/1800 MHz/1900 MHz
DATA	GPRS: UL 85.6 kbit/s; DL 85.6 kbit/s
	EDGE: UL 236.8 kbit/s; DL 236.8 kbit/s
	WCDMA PS: UL 384 kbit/s; DL 384 kbit/s
	HSPA+: UL 5.76 Mbit/s; DL 21.6 Mbit/s
GSM Voice	Optional
Sensitivity	-110dBm
3G antenna gain	3.3 dB
GPS	
GPS module	u-blox M7
Receiver Type	L1 frequency band, C/A code, 22 tracking
Sensitivity	-165dBm (tracking), -148dBm (Acquisition)
GPS antenna gain	Built in antenna 1.5dB, external antenna: 3dB
Accuracy	≥15m(position),0.1m/s(velocity)
Acquisition Time	36s (cold start)
	33s (warm start)
	1s (hot start)
	<1s (Re-Acquisition)
Upload frequency	1 Hz
General	
Power	8-32V
Power consumption	<6W
Dimension	29*123*193mm
Working temperature	-20°C ~ +70°C

Storage temperature -40°C ~ +80°C

Protection IP64

Vibration test 5-300HZ, 2G

Cable

1, 5557 2x3 pin external port (font view)

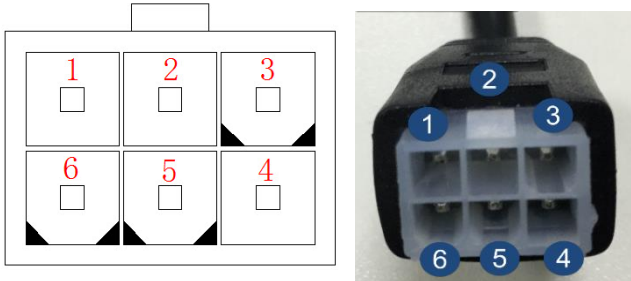

5557 2x3 pin port		
Pin No.	Definition	Description
1	RS232 TX	RS232 Transmission
2	RS232 RX	RS232 Reception
3	Device GND	RS232 GND
4	ACC	ACC input
5	Power +	Battery positive pole
6	Power GND	Ground

2, 5557 2x4pin external port (front view)

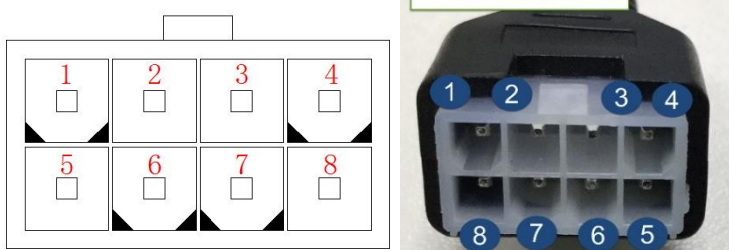

5557 2x4pin port		
Pin No.	Definition	Description
1	Input 1	Input detection 1
2	Input 2	Input detection 2
3	Input 3	Input detection 3
4	Device GND	Device ground
5	12V out	12V output
6	CVBS2	External video signal input 1 (4 Pin aviation interface)
7	Device GND	Device ground
8	CVBS1	External video signal input 1(4 Pin aviation interface)